

## Specifications:

Model	Colour code curve	Bore mm	Motor output kW	Rated current A	Head max. m	Capacity max. l/min	Dry weight kg w/o cable	Max. solid handling ø mm	Pressure resistance max. m	Cable length m
15-BER	1			3,5			43,0			

This submersible aerator is composed of a B-type pump and an ejector (suction mechanism) so that both agitation and aeration can be carried out simultaneously. The BER aerator features extremely high oxygen dissolution efficiency and a non clog shaver mechanism.

ø Air inlet		32mm, 50mm		
Pumping Fluid	Temperature	0-40°C		
	Type of Fluid	Municipal sewage, sewage of food industry		
Pump	Components	Impeller	Non-clog impeller	
		Shaft Seal	Double mechanical seal	
		Bearings	Shielded ball bearings	
	Material	Impeller	Grey iron casting EN-GJL-200	
		Casing	Grey iron casting EN-GJL-200	
		Suction Plate	Grey iron casting EN-GJL-200	
		Diffuser	Construction steel DIN1.0040 nylon coated	
Shaft Seal	Silicon carbide in oil bath			
Motor	Insulation		Insulation class F	
	Type, Poles		Induction motor, 2 poles, IP68	
	Lubrication		Turbine oil (ISO VG32)	
	Motor Protector (built-in)		Circle thermal cut-out	
	Phase / Voltage		3-phase / 400V / 50Hz / d.o.l.	
	Material	Casing	Grey iron casting EN-GJL-150	
		Shaft	Stainless steel EN-X30Cr13	
Cable		Rubber, NSSHÖU		
Air pipe connection		Inside thread, flange		

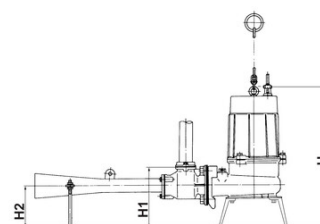
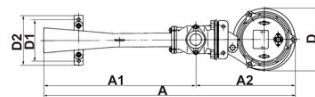
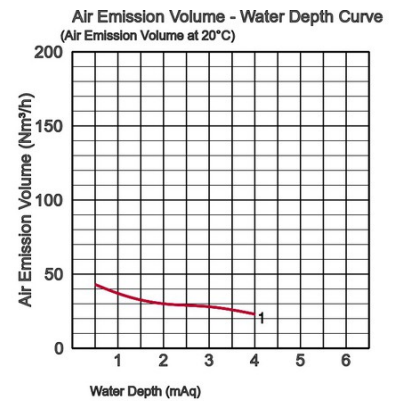

W1: lowest running water level

## Dimensions in mm:

Model	A	A1	D	D1	H
15-BER	895	537	222	150	562

Please mind: discharge bend, duck foot bend and stand set are accessories and must be ordered separately