

## Specifications:

Model	Colour code curve	Bore mm	Motor output kW	Rated current A	Head max. m	Capacity max. l/min	Dry weight kg w/o cable	Max. solid handling ø mm	Pressure resistance max. m	Cable length m
50GY23.1H	● 1			6,4	38,3	395	49,8		20	

ø Discharge bore mm		50mm		
Pumping Fluid	Temperature	0-35°C		
	Type of Fluid	Municipal sewage		
Pump	Components	Impeller	Multi-vane channel impeller with cutting mechanism	
		Shaft Seal	Double mechanical seal	
		Bearings	Shielded ball bearings	
	Material	Impeller	Grey iron casting EN-GJL-250	
		Casing	Grey iron casting EN-GJL-250	
		Shaft Seal	SiC, upper in oil bath	
		Cutting device	Stainless steel EN-X39CrMo17-1	
Motor	Insulation		Insulation class H	
	Type, Poles		Induction motor, 2 poles, IP68	
	Motor Protector (built-in)		Miniature protector	
	Lubrication		Turbine oil (ISO VG32)	
	Phase / Voltage		3-phase / 400V / 50Hz / d.o.l.	
	Material	Casing	Grey iron casting EN-GJL-250	
		Shaft	Stainless steel EN-X5CrNiMo17-12-2	
Cable		Rubber, 10m H07RN8-F		
Discharge Connection		Flange DIN/ANSI DN50 (PN10)		
Optional Accessories		Guide rail fitting "TOS" (guide support, duck foot bend, lifting chain) / Bend and stand set for free standing types		

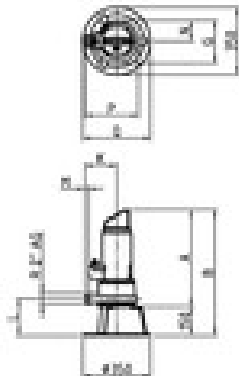
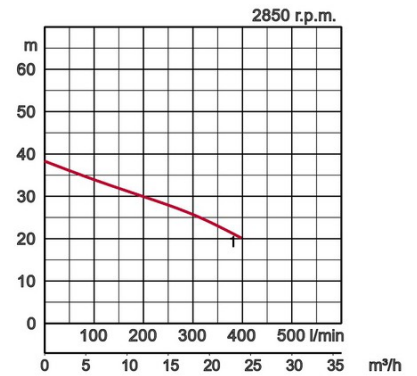

## Dimensions in mm:

Model	A	B
50GY23.1H	505	655

W1: lowest running water level

Please mind: discharge bend, duck foot bend and stand set are accessories and must be ordered separately