

## Specifications:

| Model    | Colour code curve | Bore mm | Motor output kW | Rated current A | Head max. m | Capacity max. l/min | Dry weight kg w/o cable | Max. solid handling ø mm | Pressure resistance max. m | Cable length m |
|----------|-------------------|---------|-----------------|-----------------|-------------|---------------------|-------------------------|--------------------------|----------------------------|----------------|
| KRS-65.5 | ● 1               | 150     | 5,5             | 12,1            | 17,0        | 3180                | 118,0                   | 20                       | 15                         | 20             |

|                      |                            |   |                                   |
|----------------------|----------------------------|---|-----------------------------------|
| ø Discharge bore mm  |                            | 150   |                                   |
| Pumping Fluid        | Temperature                | 0-40°C  |                                   |
|                      | Type of Fluid              | Spring water, Rain water, Ground water, Sand carrying water |                                   |
| Pump                 | Components                 | Impeller  | Semi-open type impeller           |
|                      |                            | Shaft Seal  | Double mechanical seal            |
|                      |                            | Bearings  | Shielded ball bearings            |
|                      | Material                   | Impeller  | Ductile iron casting EN-GJS-700-2 |
|                      |                            | Casing  | Grey iron casting EN-GJL-200      |
|                      |                            | Shaft Seal  | Silicon carbide in oil bath       |
| Motor                | Phase / Voltage            |   | 3-phase / 400V / 50Hz / d.o.l.    |
|                      | Motor Protector (built-in) |   | Circle thermal cut-out            |
|                      | Lubrication                |   | Turbine oil (ISO VG32)            |
|                      | Type, Poles                |   | Induction motor, 4 poles, IP68    |
|                      | Insulation                 |   | Insulation class E                |
|                      | Material                   | Casing  | Grey iron casting EN-GJL-150      |
|                      |                            | Shaft   | Stainless steel EN-X30Cr13        |
| Cable                |                            | Rubber, NSSHÖU  |                                   |
| Discharge Connection |                            | Threaded flange   |                                   |

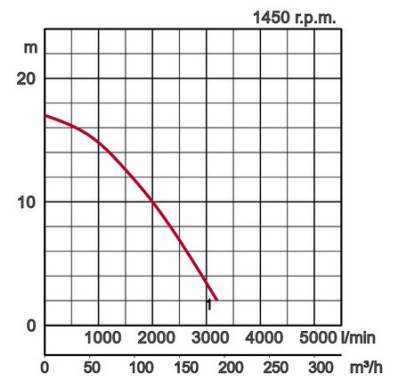

## Dimensions in mm:

| Model    | A   | A1  | B   | B1  | D   | H   | W1  |
|----------|-----|-----|-----|-----|-----|-----|-----|
| KRS-65.5 | 423 | 303 | 790 | 608 | 369 | 698 | 190 |

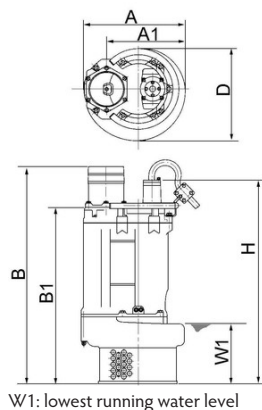

In the event of abrasive and corrosive utilization, stronger wear and tear will take place naturally in certain components. In this regard, please pay attention to our website [www.tsurumi.eu/english/applications.htm](http://www.tsurumi.eu/english/applications.htm).